

General Plan

Common Areas

Common Areas › m²

Swimming Pool › 77,65 m²

Garden › 67,60 m²

Paved Area › 667,80 m²

Changing Room › 4,35 m²

Chemical Store › 2,25 m²

Installations › 1,80 m²

Total Areas › m²

Common Areas › 794,40 m²

Basement 1 › 814,30 m²

Basement 2 › 834,00 m²

Basement 3 › 760,30 m²

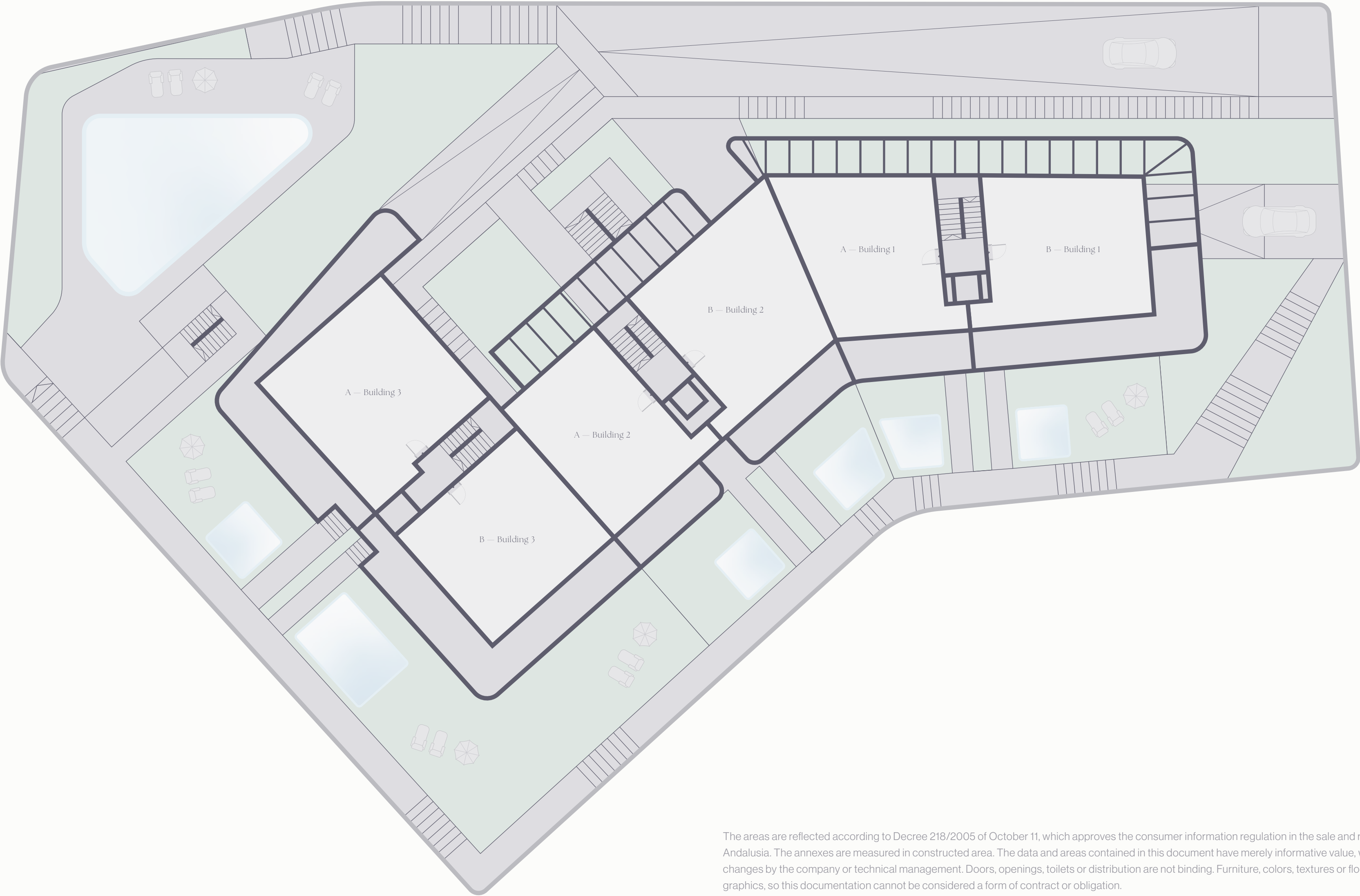
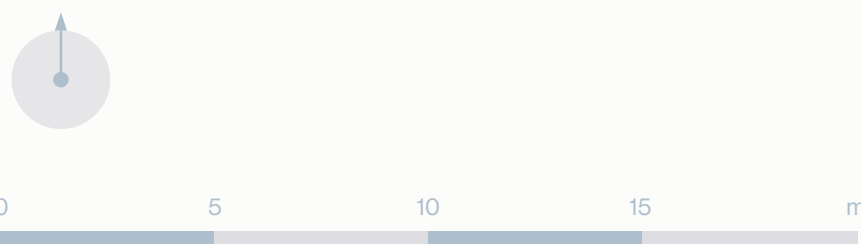

The areas are reflected according to Decree 218/2005 of October 11, which approves the consumer information regulation in the sale and rental of homes in Andalusia. The annexes are measured in constructed area. The data and areas contained in this document have merely informative value, which may be subject to changes by the company or technical management. Doors, openings, toilets or distribution are not binding. Furniture, colors, textures or flooring are only indicative graphics, so this documentation cannot be considered a form of contract or obligation.

Basement 1

Common & Parking Areas

Common Areas › m²

- Cinema › 15,40 m²
- Coworking › 33,90 m²
- Gym › 31,40 m²
- Spa › 46,90 m²

Parking Areas › m²

- Parking 29 › 10,80 m²
- Parking 30 › 10,80 m²
- Parking 31 › 10,80 m²
- Parking 32 › 10,80 m²
- Parking 33 › 11,70 m²
- Parking 34 › 10,80 m²
- Parking 35 › 10,80 m²
- Parking 36 › 10,80 m²
- Parking 37 › 12,30 m²

Storage Room Areas › m²

- | | |
|----------------------|----------------------|
| Storage 29 › 4,00 m² | Storage 31 › 4,00 m² |
| Storage 30 › 3,90 m² | Storage 32 › 3,90 m² |

Storage Room Areas › m²

- | | |
|----------------------|----------------------|
| Storage 33 › 4,40 m² | Storage 36 › 3,90 m² |
| Storage 34 › 4,00 m² | Storage 37 › 4,60 m² |
| Storage 35 › 3,90 m² | |

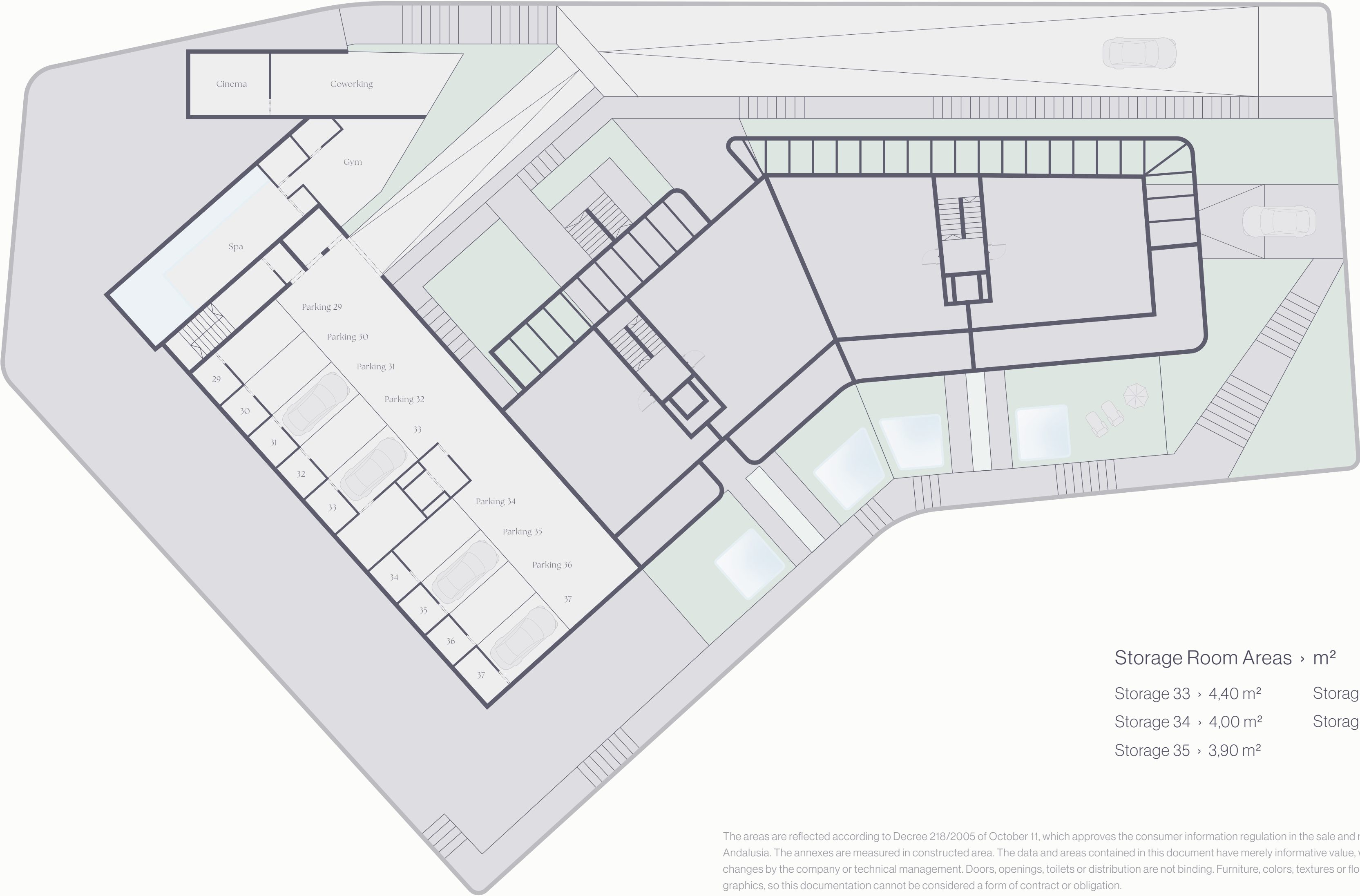
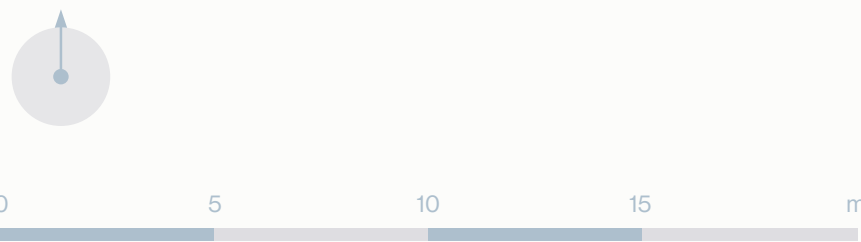

The areas are reflected according to Decree 218/2005 of October 11, which approves the consumer information regulation in the sale and rental of homes in Andalusia. The annexes are measured in constructed area. The data and areas contained in this document have merely informative value, which may be subject to changes by the company or technical management. Doors, openings, toilets or distribution are not binding. Furniture, colors, textures or flooring are only indicative graphics, so this documentation cannot be considered a form of contract or obligation.

Basement 2

Parking & Storage Areas

Parking Areas › m²

- Parking 15 › 10,80 m²
- Parking 16 › 10,80 m²
- Parking 17 › 10,80 m²
- Parking 18 › 10,80 m²
- Parking 19 › 11,70 m²
- Parking 20 › 10,80 m²
- Parking 21 › 10,80 m²
- Parking 22 › 10,80 m²
- Parking 23 › 12,30 m²
- Parking 24 › 11,00 m²
- Parking 25 › 11,00 m²
- Parking 26 › 11,00 m²
- Parking 27 › 11,00 m²
- Parking 28 › 17,30 m²

Storage Room Areas › m²

- | | |
|----------------------|----------------------|
| Storage 15 › 4,00 m² | Storage 18 › 3,90 m² |
| Storage 16 › 3,90 m² | Storage 19 › 4,40 m² |
| Storage 17 › 3,90 m² | Storage 20 › 4,00 m² |

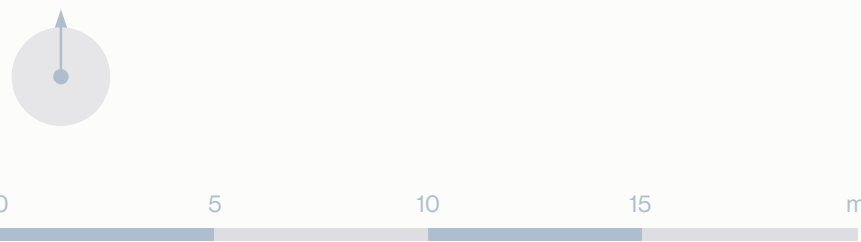

Storage Room Areas › m²

- | | |
|----------------------|----------------------|
| Storage 21 › 3,90 m² | Storage 25 › 3,40 m² |
| Storage 22 › 3,90 m² | Storage 26 › 5,20 m² |
| Storage 23 › 4,60 m² | Storage 27 › 6,90 m² |
| Storage 24 › 3,70 m² | Storage 28 › 4,10 m² |

The areas are reflected according to Decree 218/2005 of October 11, which approves the consumer information regulation in the sale and rental of homes in Andalusia. The annexes are measured in constructed area. The data and areas contained in this document have merely informative value, which may be subject to changes by the company or technical management. Doors, openings, toilets or distribution are not binding. Furniture, colors, textures or flooring are only indicative graphics, so this documentation cannot be considered a form of contract or obligation.

Basement 3

Parking & Storage Areas

Parking Areas › m²

- Parking 01 › 10,80 m²
- Parking 02 › 10,80 m²
- Parking 03 › 10,80 m²
- Parking 04 › 10,80 m²
- Parking 05 › 11,70 m²
- Parking 06 › 10,80 m²
- Parking 07 › 10,80 m²
- Parking 08 › 10,80 m²
- Parking 09 › 12,30 m²
- Parking 10 › 11,00 m²
- Parking 11 › 11,00 m²
- Parking 12 › 11,00 m²
- Parking 13 › 11,00 m²
- Parking 14 › 17,30 m²

Storage Room Areas › m²

- | | |
|----------------------|----------------------|
| Storage 01 › 4,00 m² | Storage 04 › 3,90 m² |
| Storage 02 › 3,90 m² | Storage 05 › 4,40 m² |
| Storage 03 › 3,90 m² | Storage 06 › 4,00 m² |

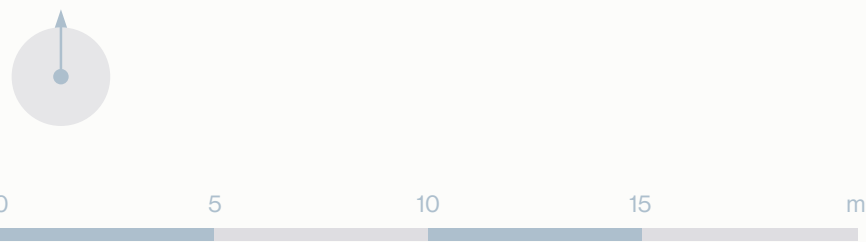

Storage Room Areas › m²

- | | |
|----------------------|----------------------|
| Storage 07 › 3,90 m² | Storage 11 › 3,40 m² |
| Storage 08 › 3,90 m² | Storage 12 › 5,20 m² |
| Storage 09 › 4,60 m² | Storage 13 › 6,90 m² |
| Storage 10 › 3,70 m² | Storage 14 › 4,10 m² |

The areas are reflected according to Decree 218/2005 of October 11, which approves the consumer information regulation in the sale and rental of homes in Andalusia. The annexes are measured in constructed area. The data and areas contained in this document have merely informative value, which may be subject to changes by the company or technical management. Doors, openings, toilets or distribution are not binding. Furniture, colors, textures or flooring are only indicative graphics, so this documentation cannot be considered a form of contract or obligation.





