

# APARTAMENTO 912

PORTAL 9 - Planta Primera  
1 Dormitorio, 1 Baño

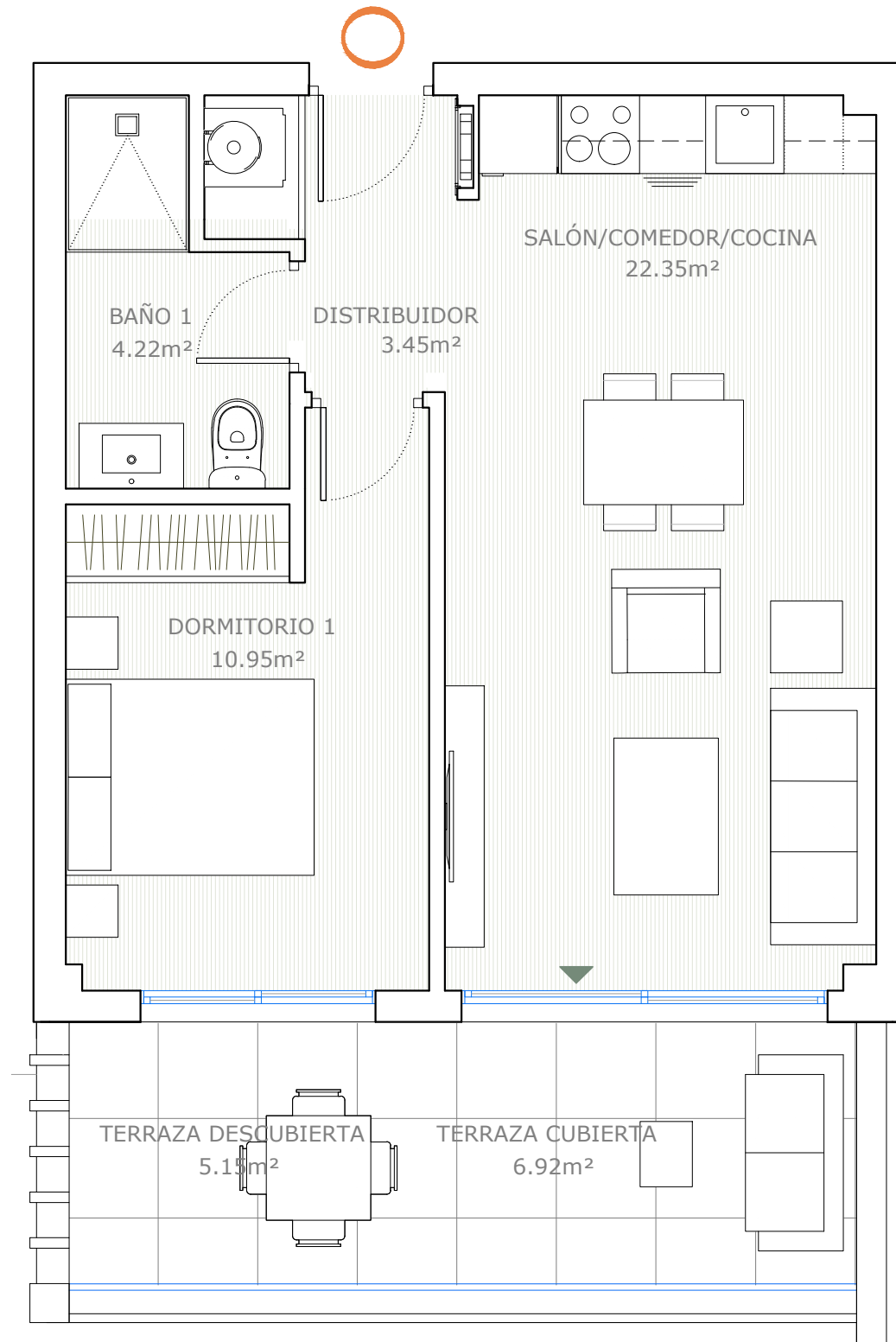

|                              |                            |
|------------------------------|----------------------------|
| SUP. CONSTRUIDA INTERIOR     | 46,78 m <sup>2</sup>       |
| SUP. CONSTRUIDA EXTERIOR     | 14,30 m <sup>2</sup>       |
| <b>TOTAL SUP. CONSTRUIDA</b> | <b>61,08 m<sup>2</sup></b> |

|                                 |                            |
|---------------------------------|----------------------------|
| <b>SUPERFICIE ÚTIL VIVIENDA</b> | <b>40,97 m<sup>2</sup></b> |
| SUP. TERRAZA CUBIERTA           | 6,92 m <sup>2</sup>        |
| SUP. TERRAZA DESCUBIERTA        | 5,15 m <sup>2</sup>        |
| <b>TOTAL SUP. ÚTILES</b>        | <b>53,04 m<sup>2</sup></b> |

SUP. ÚTIL VIVIENDA  
D 218/2005 45,07 m<sup>2</sup>

SUP. CONS VIV. + pp ZZCC  
D 218/2005 60,19 m<sup>2</sup>

Superficies calculadas conforme al Decreto 218/2005 de Andalucía

