

RESIDENCE 30

BLOCK 7 TYPE 2

BUILT AREA

Living Area	155,42m ²
Terrace Area	26,50m ²
Garden & Parking	45,53m ²
Total Built Area:	227,45m ²

ACCORDING TO D. 218/2005

Useful Area	145,20m ²
Built Area	180,72m ²

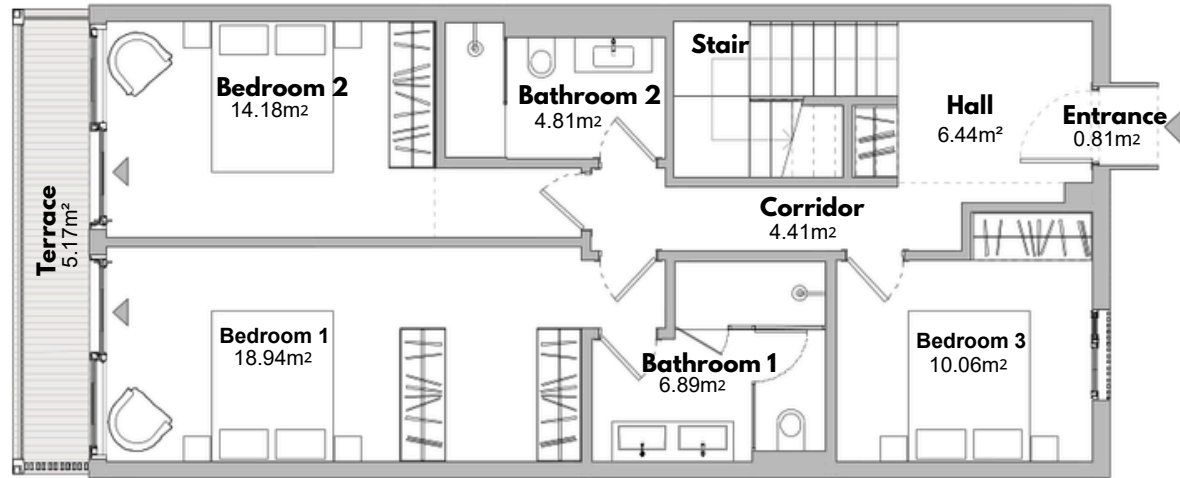
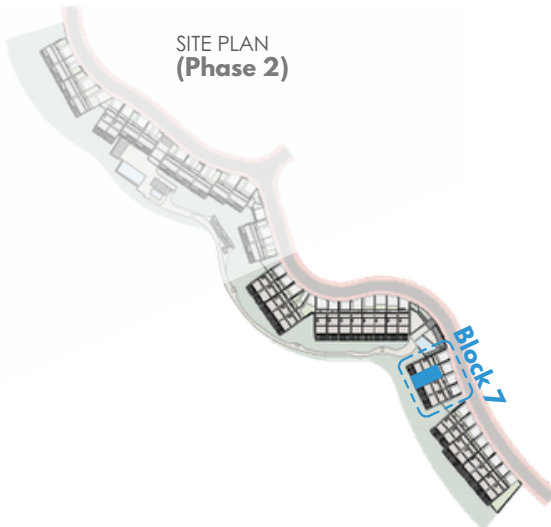

GROUND FLOOR PLAN (Entrance Level)

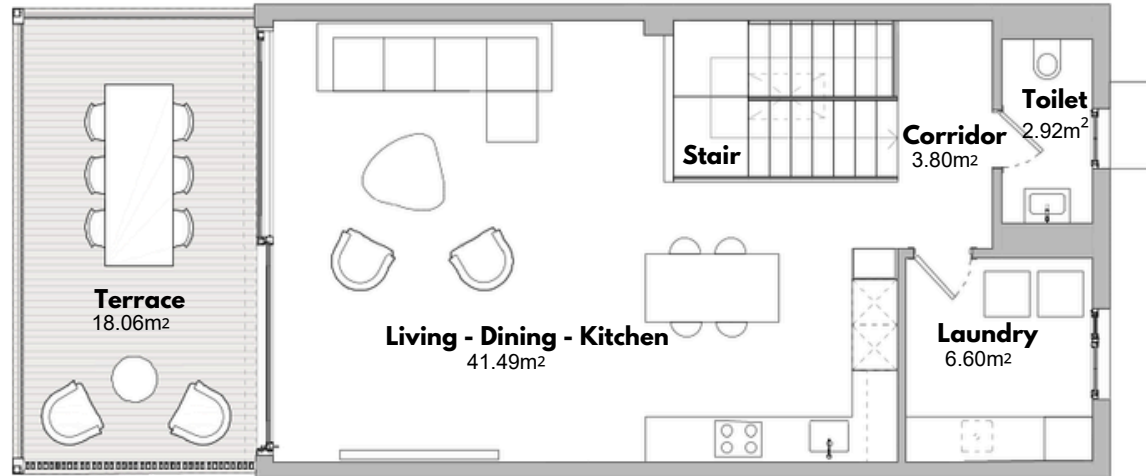

FIRST FLOOR PLAN (Upper Level)



Scale Bar (metres)



RESIDENCE 30

**BLOCK 7
TYPE 2**

BUILT AREA	
Living Area	155,42m ²
Terrace Area	26,50m ²
Garden & Parking	45,53m ²
Total Built Area:	227,45m ²
ACCORDING TO D. 218/2005	
Useful Area	145,20m ²
Built Area	180,72m ²

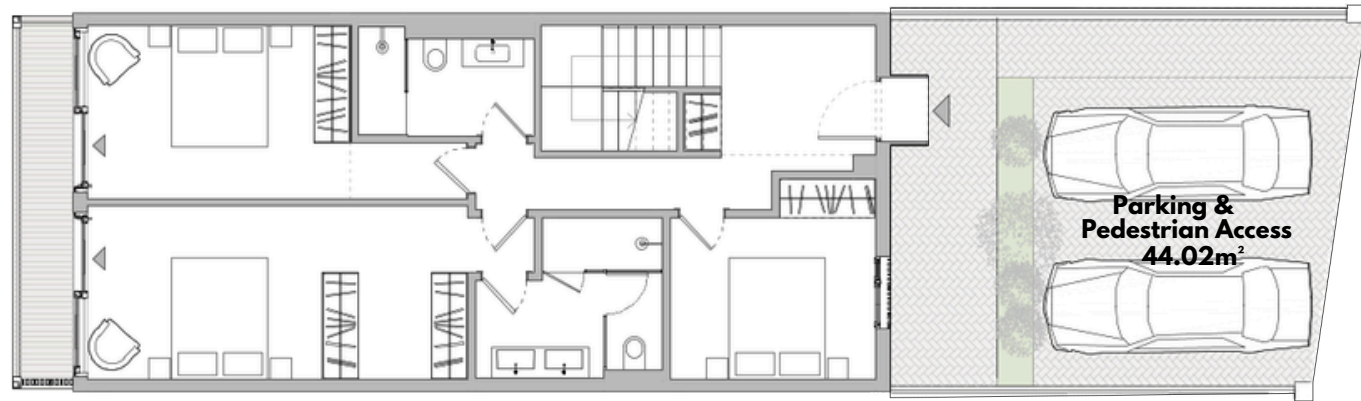

**HOUSE + ENTRANCE + PARKING
(Entrance Level)**

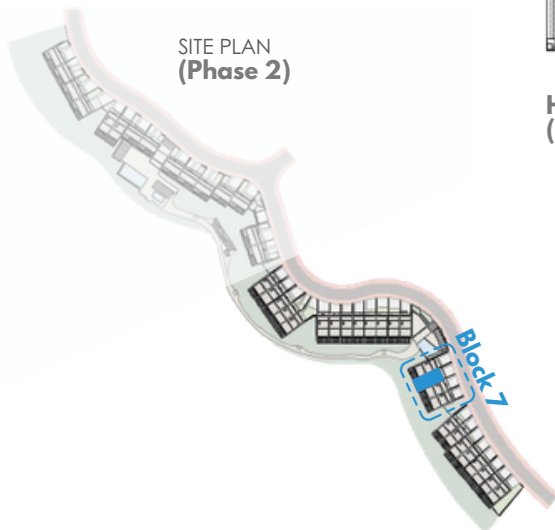

**SITE PLAN
(Phase 2)**

